

to City i e Sc oo ist ct

Business Services

Contracts Office

5735 47th Avenue Sacramento, CA 95824
(916) 643-2464

Gerardo Castillo, Chief Business Officer
Kimberly Teague, Contract Specialist

/

id o 0525-402

~~Private - August 15, 2016~~

TABLE OF CONTENTS

Procurement and Contracting Requirements

Division 0	Section	Title
	00 01 01	Project Title Page
	00 01 10	Table of Contents
	00 01 15	List of Drawings and Tables

Division 0	Section	Title
	00 11 16	Notice to Bidders

Instructions for Bidders

Division 0	Section	Title
	00 21 13	Instructions to Bidders
	00 21 13.1	Bidder Information and Forms

Available Information

Division 0	Section	Title
	00 31 19	Existing Conditions
	00 31 32	Geotechnical Data

Procurement Form

Division 0	Section	Title
	00 41 13	Bid Form and Proposal
	00 43 13	Bid Bond
	00 43 36	Designated Subcontractors List
	00 45 01	Site Visit Certification
	00 45 19	Non-Collusion Declaration

LIST OF DRAWINGS AND TABLES

DRAWINGS

<u>Sheet number</u>	<u>Description</u>
L-1	Layout Plan
L-2	Grading Plan
L-3	Irrigation Plan
L-4	Construction Details
L-5	Irrigation Details

END OF DOCUMENT

NOTICE TO BIDDERS

1 Notice is hereby given that the governing board ("Board") of the Sacramento City Unified School District ("District") will receive sealed bids for the following project: Bid No. 0525-402

[REDACTED]

[REDACTED]

[REDACTED]

Outdoor Learning Area and Landscaping at John F. Kennedy High School ("Project" or "Contract"):

2 The Project consists of landscaping, irrigation, grading, concrete, decomposed granite walkways, and exterior furniture, materials and specifications prepared by Great Valley

[REDACTED]

[REDACTED]

[REDACTED]

[REDACTED]

10. **A mandatory pre-bid conference and site visit will be held on August 9, 2016, at 8:00 a.m. at 6715 Claris Drive, Sacramento, CA 95831. All participants are required to meet in**

[REDACTED]

front of the school, near the flagpole. Bidders are required to arrive for the pre-bid conference on time and to sign an attendance list.

11. The successful Bidder shall be required to furnish a 100% Performance Bond and a 100% Payment Bond if it is awarded the contract for the Work.

12. The successful Bidder may substitute securities for any monies withheld by the District to ensure performance under the Contract, in accordance with the provisions of section 22300 of the Public Contract Code.

13. ~~The Contractor and all Subcontractors under the Contractor shall pay all workers on all work~~

[REDACTED]

performed pursuant to this Contract not less than the general prevailing rate of per diem

[REDACTED]

INSTRUCTIONS TO BIDDERS

Contractors shall follow the instructions in this document and shall submit all documents, forms

[REDACTED]

[REDACTED]

and information required for consideration of a Bid.

Sacramento City Unified School District ("District") will evaluate information submitted by the

[REDACTED]

apparent low Bidder and, if incomplete or unsatisfactory to District, Bidder's bid may be rejected at the sole discretion of District.

17 Bids are requested for a general construction contract, or work described in general, for the

[REDACTED]

[REDACTED]

of Bidder's failure to enter into the Contract would be extremely difficult and impractical to determine and that the amount of the Bidder's required bid security shall be the agreed and

conclusively presumed amount of damages.

24. Bidders must submit with the Bid the Designated Subcontractors List for those subcontractors who will perform any portion of Work, including labor, rendering of service, or specially fabricating and installing a portion of the Work or improvement according to detailed drawings contained in the plans and specifications, in excess of one half of one percent (0.5%) of total Bid. All of the listed subcontractors are required to be registered as a public

work contractor with the Department of Industrial Relations. The subcontractor's

execute the Contract, as determined by Director of the State of California Department of Industrial Relations, are available upon request at the District's principal office. Bidders

wage rates are also available on the internet at <http://www.dir.ca.gov>.

20. Submission of Bid signifies careful examination of Contract Documents and complete

understanding of the nature, extent, and location of Work to be performed. Bidders must complete the tasks listed below as a condition to bidding, and submission of a Bid shall constitute the Bidder's express representation to District that Bidder has fully completed the

warrants, and Contractor may only rely, on the accuracy of limited types of information.

(f) ~~As to above ground conditions once built conditions shown or indicated in the~~

Contract Documents, there is no warranty, express or implied, or any representation express or implied, that such information is correctly shown or indicated. This information is verifiable by independent investigation and

33. Addenda may also be issued to modify other parts of the Contract Documents as deemed advisable by the District.
34. Each Bidder must acknowledge each Addendum in its Bid Form and Proposal by number or its Bid shall be considered non-responsive. Each Addendum shall be part of the Contract Documents. A complete listing of Addenda may be secured from the District.
35. Bids shall be based on products and systems specified in Contract Documents or listed by name in Addenda. Whenever in the Specifications any materials, process, or article is indicated or specified by grade, patent, or proprietary name, or by name of manufacturer, that Specification shall be deemed to be followed by the words "or equal." Bidder may, unless otherwise stated, offer any material, process, or article that shall be substantially equal or better in every respect to that so indicated or specified. The District is not

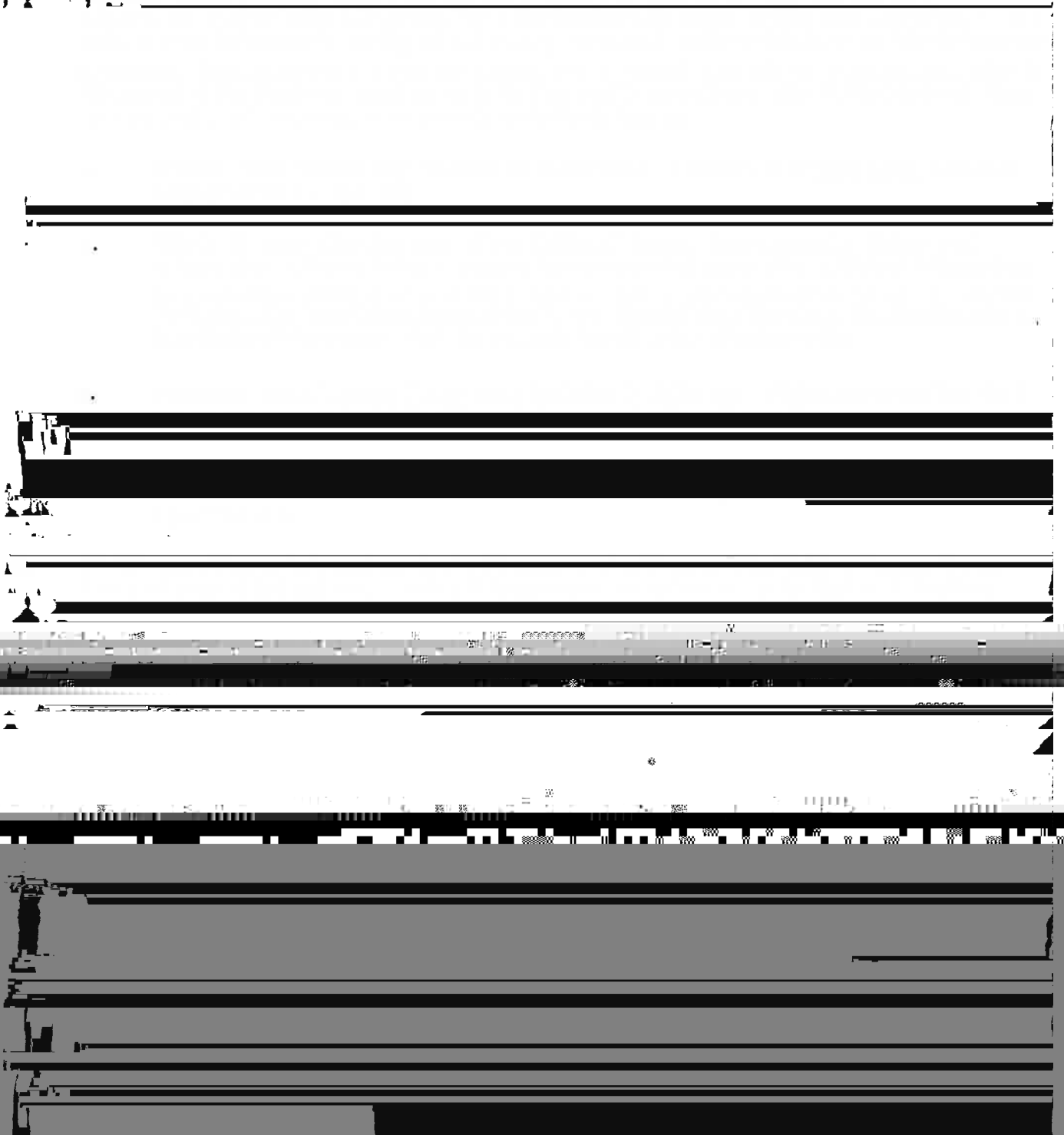

40. Time for Completion: District may issue a Notice to Proceed within **THREE (3)** months from

[REDACTED]

[REDACTED]

[REDACTED]

[REDACTED]

[REDACTED]

[REDACTED]

the date of the Notice of Award. Once Contractor has received the Notice to Proceed, Contractor shall complete the Work within the period of time indicated in the Contract

[REDACTED]

[REDACTED]

[REDACTED]

[REDACTED]

[REDACTED]

[REDACTED]

[REDACTED]

Documents.

[REDACTED]

[REDACTED]

k. Imported Materials Certification. **[IF APPLICABLE]**

1. Criminal Background Investigation/Fingerprinting Certification

District, before 5:00 p.m. of the _____ business day following bid opening.

- a. Only a Bidder who has actually submitted a bid, and who could be awarded the Contract if the bid protest is upheld, is eligible to submit a bid protest. Subcontractors are not eligible to submit bid protests. A Bidder may not rely on the bid protest

the bidder is unqualified or of doubtful financial ability or fails to meet any other pertinent standard or criteria established by District. District also reserves the right to waive

inconsequential deviations not involving price, time, or changes in the Work. For purposes of

this paragraph, an "unbalanced bid" is one having nominal prices for some work items and/or

BIDDER INFORMATION AND FORMS

DETERMINATION OF BIDDER RE

The Public Contract Code requires that school districts, in certain circumstances, bid and award public contracts to the lowest and bidder. California law establishes a very

[REDACTED]

comprehensive standard concerning bidder responsibility such that a school agency has wide

[REDACTED]

discretion and broad authority to make its determination of bidder responsibility on a case by case

[REDACTED]

Debt

Total Debt

c

g

Total Net
Worth

d

c / d

h

g / h

3. Licensing: Your License Number: _____ (Bidder must be a licensed contractor in California for the appropriate classification for the project being advertised.)

a. Has your license ever been revoked or suspended?

YES NO If yes, please explain (include dates, alleged misconduct, findings, and terms of the revocation or suspension)

b. Has a complaint ever been filed with the Contractor's State License Board against your company that required a formal hearing or inquiry?

YES NO If yes, provide explanation

c. Have you ever been licensed in California under a different name or license number?

YES NO If yes, provide name and/or license number.

Was that license ever revoked or suspended?

YES NO If yes, provide explanation

4. Safety: Has Cal OSHA, Federal OSHA, the EPA or any Air Quality Management District cited your firm in the past three (3) years?

YES NO If yes, attach a copy and description of each citation.

5. Arbitration and Litigation History: Has your firm had any claims, litigation, or disputes ending in mediation or arbitration, or termination for cause associated with any project (either by your company or against your company) in the past five (5) years?

6. Prior Disqualifications, Criminal Matters, and Related Civil Suits:

a. Has your firm ever been disqualified from performing work for the Sacramento City Unified School District?

YES NO If yes, provide the following information:

Project name:

Date of disqualification:

Duration of disqualification:

Reason for disqualification:

b. Has your firm ever been disqualified from performing work for any contracting entity other than the Sacramento City Unified School District:

YES NO If yes, provide the following information:

Contracting Entity Name:

Date of disqualification:

Duration of disqualification:

Reason for disqualification:

Has your firm or any of its owners, officers or partners ever been found liable in a civil suit or

Questionnaire Certification

I, [REDACTED], certify that the information submitted to the [REDACTED]

[REDACTED]

[REDACTED]

[REDACTED]

I, [REDACTED], certify that this declaration was executed by the undersigned on

[REDACTED]

[REDACTED]

[REDACTED]

46. Summary

This document describes existing conditions at or near the Project, and use of information available regarding existing conditions. This document is **not** part of the Contract

and shall not be construed as a representation of the Contractor's knowledge of the Site. See General Conditions for definition(s) of terms used herein.

47. Details and Information on Existing Conditions

a Documents providing a general description of the Site and conditions of the Work may have been collected by Sacramento City Unified School District ("District"), its consultants, contractors, and tenants. These documents may include previous

contracts, contract specifications, tenant improvement contracts, as-built drawings, utility drawings, and information regarding underground facilities.

Information regarding existing conditions may be inspected at the District offices or

performance of its own independent investigation that Contractor must perform as a condition to bidding and Contractor should not and shall not rely on this information or any other information supplied by District regarding existing conditions.

[REDACTED]

respect to existing underground facilities at or contiguous to the Project may be based upon information and data furnished to District by the District's employees and/or consultants or builders of such underground facilities or others. District does not

[REDACTED]

[REDACTED]

GEOTECHNICAL DATA

50. Summary

This document describes geotechnical data at various the Project that is in the District's

possession available for Contractor's review, and use of data resulting from various investigations. This document is **not** part of the Contract Documents. See General Conditions for definition(s) of terms used herein.

51. Geotechnical Reports

a Geotechnical reports may have been prepared for and around the Site by soil investigation engineers hired by Sacramento City Unified School District ("District"), and its consultants, contractors, and tenants.

b Geotechnical reports may be inspected at the District offices or the Construction

Managers's offices. If any and copies may be obtained at cost of reproduction and

The term "technical data" does not include, and Bidder may not rely upon, any other data, interpretations, opinions or information shown or indicated in such drawings or reports that otherwise relate to subsurface conditions or described structures.

- (2) The term "technical data" shall not include the location of underground facilities.

purposes of bidding or construction. Bidder may rely upon the general accuracy of the "technical data" contained in such reports or drawings.

[Redacted text block]

From: (Proper Name of Bidder)

NS

The General Conditions and definitions therein are accessible on the SCUSD website at [Redacted]

and are an integral part of the Contract Documents

[Redacted text block]

identified specific work, Contractor has submitted a price for that work or the District has proposed a price for that work, the District has accepted the cost for that work, and the District has prepared a change order incorporating that work. Contractor hereby authorizes the District to execute a unilateral deductive change order at or near the end of the Project for all or any portion of the allowance not allocated.

55. The undersigned has reviewed the Work outlined in the Contract Documents and fully understands the scope of Work required in this Proposal, understands the construction and project management function(s) is described in the Contract Documents, and that each

[REDACTED]

[REDACTED]

[REDACTED]

the District, and agrees that its Proposal, if accepted by the District, will be the basis for the

[REDACTED]

[REDACTED]

bidder to enter into a contract with the District in accordance with the intent of the Contract

[REDACTED]

operation of the Work that may create, during the Work, unusual or peculiar unsafe

[REDACTED]

conditions hazardous to persons and property.

It is hereby acknowledged that it is aware of such peculiar risks and that it has the skill

[REDACTED]

and experience to foresee and to adopt protective measures to adequately and safely perform

[REDACTED]

Secretary:

Treasurer:

Manager:

END OF DOCUMENT

(Affix Corporate Seal)

Principal

By

(Affix Corporate Seal)

Surety

By

Name of California Agent of Surety

Address of California Agent of Surety

Telephone Number of California Agent of Surety

Bidder must attach Power of Attorney and Certificate of Authority for Surety and a

[Redacted area containing multiple horizontal lines, likely representing a table or a list of items that have been obscured for security or privacy reasons.]

Insurance must authorize the Surety to be an admitted Surety Insurer.

Subcontractor Name:

CA Cont. Lic. #: _____ Location: _____

Portion of Work:

Subcontractor Name:

CA Cont. Lic. #:

Location:

Subcontractor Name:

CA Cont. Lic. #:

Location:

Portion of Work:

Subcontractor Name:

CA Cont. Lic. #:

Location:

Portion of Work:

Subcontractor Name:

CA Cont. Lic. #:

Location:

Portion of Work:

Date:

Proper Name of Bidder:

SITE VISIT CERTIFICATION

TO BE EXECUTED BY BIDDER AND SUBMITTED WITH BID
IF SITE VISIT WAS MANDATORY

PROJECT: Outdoor Learning Area and Landscaping at John F. Kennedy High School

Check option that applies: _____

_____ I certify that I visited the Site of the proposed Work and became fully acquainted with the

restrictions attending the execution of the Work under contract.

**NON-COLLUSION DECLARATION
TO BE EXECUTED BY BIDDER AND SUBMITTED WITH BID
ode Section 7106**

The undersigned declares:

[REDACTED]

The bid is not made in the interest of, or on behalf of, any undisclosed person, partnership, company, association, organization, or corporation. The bid is genuine and not collusive or sham.

The bidder has not directly or indirectly induced or solicited any other bidder to put in a false or sham bid. The bidder has not directly or indirectly colluded, conspired, connived, or agreed with any

[REDACTED]

sham bid. The bidder has not directly or indirectly colluded, conspired, connived, or agreed with any

POI
END OF
EXISTING FENCE

— EXISTING LANDSCAPE —

— EXISTING LANDSCAPE —

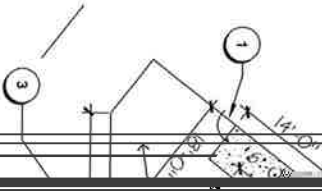

LAYOUT NOTES

1. ALL ANGLES NOT TO SCALE
2. ADJUST LAYOUT TO MATCH EXISTING PAVING
3. TRAILS AND PAVING LAYOUT PER SCULPTOR'S LAYOUT
4. MOUND LOCATION PER SCULPTOR'S REPRESENTATION
5. FURNITURE AND VAS
6. EXISTING EQUIPMENT

SEE SHEET L-2 FOR GRADING PLANS.

SEE SHEET L-3 FOR IRRIGATION PLANS.

SEE SHEET L-4 AND L-5 FOR IRRIGATION AND CONSTRUCTION DETAILS.

NEW CONCRETE TYPICAL

13. EXISTING CONTAINER NUMBER SHOWN AND REPAIR SHEET NUMBER

8. LOCATIONS OF UTILITIES APPROXIMATE, CORNER TO CORNER
9. ALL RADI AND CURVES TRANSITIONS, WITHOUT ALL FORMS AND ALIGN CONSTRUCTION BY SC
11. ANY SITE DIMENSION D BROUGHT TO THE ATTENTION OF THE ARCHITECT
12. EXISTING EQUIPMENT

IN AREAS OF S
HEADS PRIOR
OWNER TO DE
REMAIN, REIK
DETERMINED
ADJUST RADII
NEW HANTER
ADD LATERAL
ONLY AS NEEDED

12 GPM @ 1.5

IN A
HEAD

EXISTEN
RE-QUIRE
EXISTEN
RE-QUI

PIPE & WIRE

G/P DETAIL

NOZZLE LEGEND: 35 PSI MIN. PRESSURE

3/4" NPT M AS BULK

DATE: 10/10/08
DRAWN BY: J. H. HARRIS
CHECKED BY: J. H. HARRIS

IRI N EQ

SEE
SEE
SEE
L-1 FC
L-2 FC
L-4 AN

- 1. CONCRETE PAVING W/ #4 REBAR
- 2. CONCRETE PAVING W/ #4 REBAR
- 3. CONCRETE PAVING W/ #4 REBAR
- 4. CONCRETE PAVING W/ #4 REBAR
- 5. CONCRETE PAVING W/ #4 REBAR
- 6. CONCRETE PAVING W/ #4 REBAR
- 7. CONCRETE PAVING W/ #4 REBAR
- 8. CONCRETE PAVING W/ #4 REBAR
- 9. CONCRETE PAVING W/ #4 REBAR
- 10. CONCRETE PAVING W/ #4 REBAR
- 11. CONCRETE PAVING W/ #4 REBAR
- 12. CONCRETE PAVING W/ #4 REBAR
- 13. CONCRETE PAVING W/ #4 REBAR
- 14. CONCRETE PAVING W/ #4 REBAR
- 15. CONCRETE PAVING W/ #4 REBAR
- 16. CONCRETE PAVING W/ #4 REBAR
- 17. CONCRETE PAVING W/ #4 REBAR
- 18. CONCRETE PAVING W/ #4 REBAR
- 19. CONCRETE PAVING W/ #4 REBAR
- 20. CONCRETE PAVING W/ #4 REBAR

CONCRETE PAVING

PERFORATED STEEL BENCH

PERFORATED STEEL BENCH



TIMBER SHADE PERGOLA

TIMBER SHADE PERGOLA

GREAT VALLEY DESIGN, INC.
 LANDSCAPE ARCHITECTURE
 5113 UNIVERSITY
 121
 40
 SAK

ARCHITECTS STAMP:

PROJECT MANAGER
 SCOTT VOLMER

SCALE:

DATE:

REVISION:

SHEET NUMBER

L-4

CONSTRUCTION DETAILS

HABITAT GARDEN &
 OUTDOOR CLASSROOM

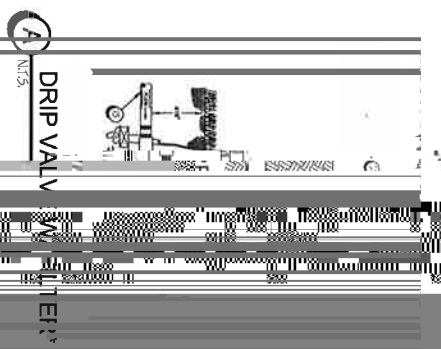

- 1
- 2
- 3
- 4
- 5
- 6
- 7
- 8
- 9
- 10
- 11
- 12
- 13
- 14
- 15
- 16
- 17
- 18
- 19
- 20
- 21
- 22
- 23
- 24
- 25
- 26
- 27
- 28
- 29
- 30
- 31
- 32
- 33
- 34
- 35
- 36
- 37
- 38
- 39
- 40
- 41
- 42
- 43
- 44
- 45
- 46
- 47
- 48
- 49
- 50
- 51
- 52
- 53
- 54
- 55
- 56
- 57
- 58
- 59
- 60
- 61
- 62
- 63
- 64
- 65
- 66
- 67
- 68
- 69
- 70
- 71
- 72
- 73
- 74
- 75
- 76
- 77
- 78
- 79
- 80
- 81
- 82
- 83
- 84
- 85
- 86
- 87
- 88
- 89
- 90
- 91
- 92
- 93
- 94
- 95
- 96
- 97
- 98
- 99
- 100

SPRAY VALVE*
N.T.S.
IF REPLACED

- 1) SPRAY VALVE WITH GUNNERS
- 2) MATTER HOSE 1/2" HOSE
- 3) 1" TAG RAIN BR
- 4) FEMALE GUNNERS RAIN NIP-HAN
- 5) VALVE BODY WITH HOSE BRD 7/8"
- 6) FINISH GROUND/C
- 7) P/C SCH 40 NIP
- 8) P/C SCH 40 EL
- 9) P/C SCH 40 NIP (LEFT HAND)
- 10) BRICK (1" x 1")
- 11) P/C MANHOLE PI
- 12) 1"
- 13) P/C SCH 40 TE
- 14) P/C SCH 40 MA
- 15) P/C LATERAL PI
- 16) 3/4" NIP
- 17) 3/4" NIP
- 18) 3/4" NIP
- 19) 3/4" NIP
- 20) 3/4" NIP
- 21) 3/4" NIP
- 22) 3/4" NIP
- 23) 3/4" NIP
- 24) 3/4" NIP
- 25) 3/4" NIP
- 26) 3/4" NIP
- 27) 3/4" NIP
- 28) 3/4" NIP
- 29) 3/4" NIP
- 30) 3/4" NIP
- 31) 3/4" NIP
- 32) 3/4" NIP
- 33) 3/4" NIP
- 34) 3/4" NIP
- 35) 3/4" NIP
- 36) 3/4" NIP
- 37) 3/4" NIP
- 38) 3/4" NIP
- 39) 3/4" NIP
- 40) 3/4" NIP
- 41) 3/4" NIP
- 42) 3/4" NIP
- 43) 3/4" NIP
- 44) 3/4" NIP
- 45) 3/4" NIP
- 46) 3/4" NIP
- 47) 3/4" NIP
- 48) 3/4" NIP
- 49) 3/4" NIP
- 50) 3/4" NIP
- 51) 3/4" NIP
- 52) 3/4" NIP
- 53) 3/4" NIP
- 54) 3/4" NIP
- 55) 3/4" NIP
- 56) 3/4" NIP
- 57) 3/4" NIP
- 58) 3/4" NIP
- 59) 3/4" NIP
- 60) 3/4" NIP
- 61) 3/4" NIP
- 62) 3/4" NIP
- 63) 3/4" NIP
- 64) 3/4" NIP
- 65) 3/4" NIP
- 66) 3/4" NIP
- 67) 3/4" NIP
- 68) 3/4" NIP
- 69) 3/4" NIP
- 70) 3/4" NIP
- 71) 3/4" NIP
- 72) 3/4" NIP
- 73) 3/4" NIP
- 74) 3/4" NIP
- 75) 3/4" NIP
- 76) 3/4" NIP
- 77) 3/4" NIP
- 78) 3/4" NIP
- 79) 3/4" NIP
- 80) 3/4" NIP
- 81) 3/4" NIP
- 82) 3/4" NIP
- 83) 3/4" NIP
- 84) 3/4" NIP
- 85) 3/4" NIP
- 86) 3/4" NIP
- 87) 3/4" NIP
- 88) 3/4" NIP
- 89) 3/4" NIP
- 90) 3/4" NIP
- 91) 3/4" NIP
- 92) 3/4" NIP
- 93) 3/4" NIP
- 94) 3/4" NIP
- 95) 3/4" NIP
- 96) 3/4" NIP
- 97) 3/4" NIP
- 98) 3/4" NIP
- 99) 3/4" NIP
- 100) 3/4" NIP

POP-UP SPRINKLER BODY
N.T.S.
IF REPLACED

- 1) POP-UP SPRINKLER BODY
- 2) LATERAL PIPE (1" I.D.)
- 3) LATERAL PIPE (1" I.D.)
- 4) 1/2" NIP (1" I.D.)
- 5) 3/4" NIP (1" I.D.)
- 6) 1/2" NIP (1" I.D.)
- 7) 3/4" NIP (1" I.D.)
- 8) 1/2" NIP (1" I.D.)
- 9) 3/4" NIP (1" I.D.)
- 10) 1/2" NIP (1" I.D.)
- 11) 3/4" NIP (1" I.D.)
- 12) 1/2" NIP (1" I.D.)
- 13) 3/4" NIP (1" I.D.)
- 14) 1/2" NIP (1" I.D.)
- 15) 3/4" NIP (1" I.D.)
- 16) 1/2" NIP (1" I.D.)
- 17) 3/4" NIP (1" I.D.)
- 18) 1/2" NIP (1" I.D.)
- 19) 3/4" NIP (1" I.D.)
- 20) 1/2" NIP (1" I.D.)
- 21) 3/4" NIP (1" I.D.)
- 22) 1/2" NIP (1" I.D.)
- 23) 3/4" NIP (1" I.D.)
- 24) 1/2" NIP (1" I.D.)
- 25) 3/4" NIP (1" I.D.)
- 26) 1/2" NIP (1" I.D.)
- 27) 3/4" NIP (1" I.D.)
- 28) 1/2" NIP (1" I.D.)
- 29) 3/4" NIP (1" I.D.)
- 30) 1/2" NIP (1" I.D.)
- 31) 3/4" NIP (1" I.D.)
- 32) 1/2" NIP (1" I.D.)
- 33) 3/4" NIP (1" I.D.)
- 34) 1/2" NIP (1" I.D.)
- 35) 3/4" NIP (1" I.D.)
- 36) 1/2" NIP (1" I.D.)
- 37) 3/4" NIP (1" I.D.)
- 38) 1/2" NIP (1" I.D.)
- 39) 3/4" NIP (1" I.D.)
- 40) 1/2" NIP (1" I.D.)
- 41) 3/4" NIP (1" I.D.)
- 42) 1/2" NIP (1" I.D.)
- 43) 3/4" NIP (1" I.D.)
- 44) 1/2" NIP (1" I.D.)
- 45) 3/4" NIP (1" I.D.)
- 46) 1/2" NIP (1" I.D.)
- 47) 3/4" NIP (1" I.D.)
- 48) 1/2" NIP (1" I.D.)
- 49) 3/4" NIP (1" I.D.)
- 50) 1/2" NIP (1" I.D.)
- 51) 3/4" NIP (1" I.D.)
- 52) 1/2" NIP (1" I.D.)
- 53) 3/4" NIP (1" I.D.)
- 54) 1/2" NIP (1" I.D.)
- 55) 3/4" NIP (1" I.D.)
- 56) 1/2" NIP (1" I.D.)
- 57) 3/4" NIP (1" I.D.)
- 58) 1/2" NIP (1" I.D.)
- 59) 3/4" NIP (1" I.D.)
- 60) 1/2" NIP (1" I.D.)
- 61) 3/4" NIP (1" I.D.)
- 62) 1/2" NIP (1" I.D.)
- 63) 3/4" NIP (1" I.D.)
- 64) 1/2" NIP (1" I.D.)
- 65) 3/4" NIP (1" I.D.)
- 66) 1/2" NIP (1" I.D.)
- 67) 3/4" NIP (1" I.D.)
- 68) 1/2" NIP (1" I.D.)
- 69) 3/4" NIP (1" I.D.)
- 70) 1/2" NIP (1" I.D.)
- 71) 3/4" NIP (1" I.D.)
- 72) 1/2" NIP (1" I.D.)
- 73) 3/4" NIP (1" I.D.)
- 74) 1/2" NIP (1" I.D.)
- 75) 3/4" NIP (1" I.D.)
- 76) 1/2" NIP (1" I.D.)
- 77) 3/4" NIP (1" I.D.)
- 78) 1/2" NIP (1" I.D.)
- 79) 3/4" NIP (1" I.D.)
- 80) 1/2" NIP (1" I.D.)
- 81) 3/4" NIP (1" I.D.)
- 82) 1/2" NIP (1" I.D.)
- 83) 3/4" NIP (1" I.D.)
- 84) 1/2" NIP (1" I.D.)
- 85) 3/4" NIP (1" I.D.)
- 86) 1/2" NIP (1" I.D.)
- 87) 3/4" NIP (1" I.D.)
- 88) 1/2" NIP (1" I.D.)
- 89) 3/4" NIP (1" I.D.)
- 90) 1/2" NIP (1" I.D.)
- 91) 3/4" NIP (1" I.D.)
- 92) 1/2" NIP (1" I.D.)
- 93) 3/4" NIP (1" I.D.)
- 94) 1/2" NIP (1" I.D.)
- 95) 3/4" NIP (1" I.D.)
- 96) 1/2" NIP (1" I.D.)
- 97) 3/4" NIP (1" I.D.)
- 98) 1/2" NIP (1" I.D.)
- 99) 3/4" NIP (1" I.D.)
- 100) 1/2" NIP (1" I.D.)



ARCHITECTS STAMP:

PROJECT MANAGER
 SCOTT VOLBERS

SCALE:

DATE:
 MAR 14, 2016

REVISION:

SHEET NUMBER
 L-5

IRRIGATION DETAILS
 HABITAT GARDEN &
 OUTDOOR CLASSROOM